



## VISTA TIARA TOWER 4 - TOWER 6

**Developer: MB World Properties Sdn. Bhd.**

199101012056 (222368-V)

*Subsidiary of MB World Group Berhad*



Note: All renderings, illustrations, photographs, furniture, displayed units, landscape amenities or accessories are shown for illustrative purposes only and do not represent the actual design, physical or structural details of the building and/or denote any legal representations. Plans, specifications, materials, unit numbers, address, name of project and other information contained herein are intended to give a general indication of the proposed design only and are subject to change and/or amendments as may be required or as directed by the relevant authorities/ engineer(s)/ architect. All areas and other measurements are approximate only and subject to final survey and/or SIFUS approval. All statements are believed to be correct but are not to be regarded as representation of facts. Minimum charges for facilities, personnel and equipment may apply. Any models of furniture/ electrical appliances provided are up to the vendor's discretion and do not form part of any contract or warranty. While every reasonable care has been taken in preparing this website/flyer/brochure/publication/banner/poster/video and in constructing the scale models and sales gallery/show unit(s), the Developer and its related companies, representatives, consultants and agents accept no responsibility for any inaccuracies or omissions. The Sale and Purchase Agreement embodies all the terms and conditions between the Developer and the purchasers, and supersedes and cancels all previous representations, warranties, promises, inducements or statements of intention, whether in written, oral or visual made by the Developer and/or its agents which are not embodied in the Sale and Purchase Agreement. Interested persons should rely on their own inquiries.

**CONFIDENTIAL. FOR INTERNAL REFERENCE ONLY. PLEASE DO NOT DISTRIBUTE.**

**ALL INFORMATION IS SUBJECT TO CHANGE AND/OR AMENDMENTS AS MAY BE REQUIRED OR AS DIRECTED BY THE RELEVANT AUTHORITIES/ENGINEER(S)/ARCHITECT.**

[DRAFT] FOR PREVIEW ONLY. LAST UPDATED ON 17 AUGUST 2024.

All images are for illustration purpose only. Subject to change.



CONFIDENTIAL. FOR INTERNAL REFERENCE ONLY. PLEASE DO NOT DISTRIBUTE.

ALL INFORMATION IS SUBJECT TO CHANGE AND/OR AMENDMENTS AS MAY BE REQUIRED OR AS DIRECTED BY THE RELEVANT AUTHORITIES/ENGINEER(S)/ARCHITECT.

[DRAFT] FOR PREVIEW ONLY. LAST UPDATED ON 17 AUGUST 2024.

## NEARBY AMENITIES

TRANSPORTATION	EST. DISTANCE
Larkin Sentral	7.7 km
Johor Bahru Sentral	8.5 km
Future Bukit Chagar RTS Link Station	9.5 km
Johor Bahru CIQ Complex	9.5 km
Johor Bahru International Ferry Terminal	10.5 km
Senai International Airport	24.5 km
Sultan Abu Bakar ICQS Complex	25.5 km

SHOPPING CENTRE	EST. DISTANCE
Beletime Danga Bay	500 m
Angsana Johor Bahru Mall	5.5 km
Giant Tampoi	5.8 km
Paradigm Mall Johor Bahru	8 km
R&F Mall Tanjung Puteri	8.2 km
Johor Bahru City Square	8.3 km
KOMTAR JBCC	8.5 km
KSL City Mall	9.7 km
Sutera Mall	9.8 km
NSK Trade City @ Skudai	11.6 km
The Mall, Mid Valley Southkey	12.9 km
IKEA Tebrau	20.5 km
Toppen Shopping Centre	20.9 km

MEDICAL CENTRE	EST. DISTANCE
Sultanah Aminah General Hospital	5.4 km
KPJ Puteri Specialist Hospital	6.5 km
KPJ Johor Specialist Hospital	7.5 km
Columbia Asia Hospital - Tebrau	11 km
Gleneagles Hospital Medini	16.4 km
Sultan Ismail Hospital	20.6 km

RECREATION DESTINATION	EST. DISTANCE
Danga Bay Park	550 m
Tan Hiok Nee Heritage Street	7.6 km
Hutan Bandar MBBB	8 km
Johor Golf & Country Club	8.4 km
Tunku Mahkota Ismail Youth Centre	8.4 km

SCHOOLS & COLLEGES	EST. DISTANCE
Tun Fatimah School	7 km
SK & SMK Infant Jesus Convent	7.2 km
SK Temenggong Abdul Rahman 1 & 2	8.5 km
SK & SMK (P) Sultan Ibrahim	8.8 km
Foon Yew High School	11.2 km
City University Malaysia - Johor Bahru Campus	11.7 km
Universiti Teknologi Malaysia	17.8 km
EduCity	18.7 km

\*Estimated distance

**CONFIDENTIAL. FOR INTERNAL REFERENCE ONLY. PLEASE DO NOT DISTRIBUTE.**

**ALL INFORMATION IS SUBJECT TO CHANGE AND/OR AMENDMENTS AS MAY BE REQUIRED OR AS DIRECTED BY THE RELEVANT AUTHORITIES/ENGINEER(S)/ARCHITECT.**

[DRAFT] FOR PREVIEW ONLY. LAST UPDATED ON 17 AUGUST 2024.

# WELL-CONNECTED TRANSPORT NETWORK



- 1** MBW Bay is strategically located along Persiaran Abu Bakar Sultan (Skudai Highway), with easy access to other major roads such as:
  - Inner Ring Road
  - Jalan Ismail Sultan
- 2** **Future Johor Bahru-Singapore Rapid Transit System (RTS) Link**
  - Connecting Bukit Chagar in Johor Bahru and Woodlands North in Singapore - will be integrated with public transport systems at both stations;
  - Capacity of 10,000 passengers per hour per direction;
  - Malaysian ICQ and Singaporean CIQ facilities will be co-located within the same building - allowing the entire immigration process of leaving and entering both countries to be completed at the departing station;
  - For more information and latest updates, visit <https://www.mymrt.com.my/public/rts-link/>
- 3** **Complimentary One (1) Year Shuttle Bus Service to Johor Bahru Sentral**  
\* Terms and conditions apply

# FLORIAN RESIDENCES TOWER 4 - TOWER 6

<b>Project Name</b>	Florian Residences (Vista Tiara)				
<b>Developer</b>	MB World Properties Sdn. Bhd. 199101012056 (222368-V)				
<b>Location</b>	Persiaran Abu Bakar Sultan, Mukim Bandar, Daerah Johor Bahru, Johor Darul Takzim. N 1° 28' 07.2", E 103° 43' 31.8"				
<b>Site Area</b>	Approx. 3.60 acres (Parcel F1-B: Tower 4 to Tower 6)	<b>Land Tenure</b>	Freehold	<b>Total Units</b>	911
<b>Components</b>	<ul style="list-style-type: none"> <li><b>Tower 4:</b> 41-level serviced apartments (312 units)</li> <li><b>Tower 5:</b> 43-level serviced apartments (287 units)</li> <li><b>Tower 6:</b> 41-level serviced apartments (312 units)</li> </ul>		<ul style="list-style-type: none"> <li>Podium with car parks, 2 levels of commercial space and 1 level of recreational facilities</li> </ul>		



All images are for illustration purpose only. Subject to change.

**CONFIDENTIAL. FOR INTERNAL REFERENCE ONLY. PLEASE DO NOT DISTRIBUTE.**

**ALL INFORMATION IS SUBJECT TO CHANGE AND/OR AMENDMENTS AS MAY BE REQUIRED OR AS DIRECTED BY THE RELEVANT AUTHORITIES/ENGINEER(S)/ARCHITECT.**

[DRAFT] FOR PREVIEW ONLY. LAST UPDATED ON 17 AUGUST 2024.

# UNIT TYPES

Unit Details			Unit Area		No. of Unit					
Type	Room	Bathroom	sq m	sq ft	Tower 4	Tower 5	Tower 6	Total		
A6	1 Bedroom & 1 Study Area	1	60	639.00	39		39	78	156	17.1%
A6(M)	1 Bedroom & 1 Study Area	1	60	639.00	39		39	78		
A7	1 Bedroom & 1 Study Area	1	63	679.20	39		39	78	156	17.1%
A7(M)	1 Bedroom & 1 Study Area	1	63	679.20	39		39	78		
B1A	1 Bedroom & 1 Study Area	1	68	728.61	39		39	78	156	17.1%
B1A(M)	1 Bedroom & 1 Study Area	1	68	728.61	39		39	78		
B14	2 Bedrooms & 1 Study Room	2	96	Tower 4: 1029.13 Tower 6: 1027.25	39		39	78	156	17.1%
B14(M)	2 Bedrooms & 1 Study Room	2	96	Tower 4: 1029.13 Tower 6: 1027.25	39		39	78		
A4	1 Bedroom & 1 Study Area	1	50	538.95		41		41	41	4.5%
A5	1 Bedroom	1	55	592.12		41		41	41	4.5%
A8	1 Bedroom & 1 Study Area	1	64	693.10		41		41	41	4.5%
B3	1 Bedroom & 1 Study Area	1	70	747.97		41		41	41	4.5%
B7	2 Bedrooms & 1 Study Room	1	80	859.72		41		41	41	4.5%
B10	2 Bedrooms	2	83	891.85		41		41	41	4.5%
B11	2 Bedrooms	2	81	874.09		41		41	41	4.5%
<b>Total Units</b>					<b>312</b>	<b>287</b>	<b>312</b>	<b>911</b>	<b>911</b>	<b>100%</b>

CONFIDENTIAL. FOR INTERNAL REFERENCE ONLY. PLEASE DO NOT DISTRIBUTE.

ALL INFORMATION IS SUBJECT TO CHANGE AND/OR AMENDMENTS AS MAY BE REQUIRED OR AS DIRECTED BY THE RELEVANT AUTHORITIES/ENGINEER(S)/ARCHITECT.

[DRAFT] FOR PREVIEW ONLY. LAST UPDATED ON 17 AUGUST 2024.

# SITE PLAN

**NOTE:** Not to scale. Exterior areas may vary to suit site conditions. Unit numbers, plans, layouts and other information contained herein are intended to give a general indication of the proposed design only and are subject to change and/or amendments as may be required or as directed by the relevant authorities/engineer(s)/ architect.

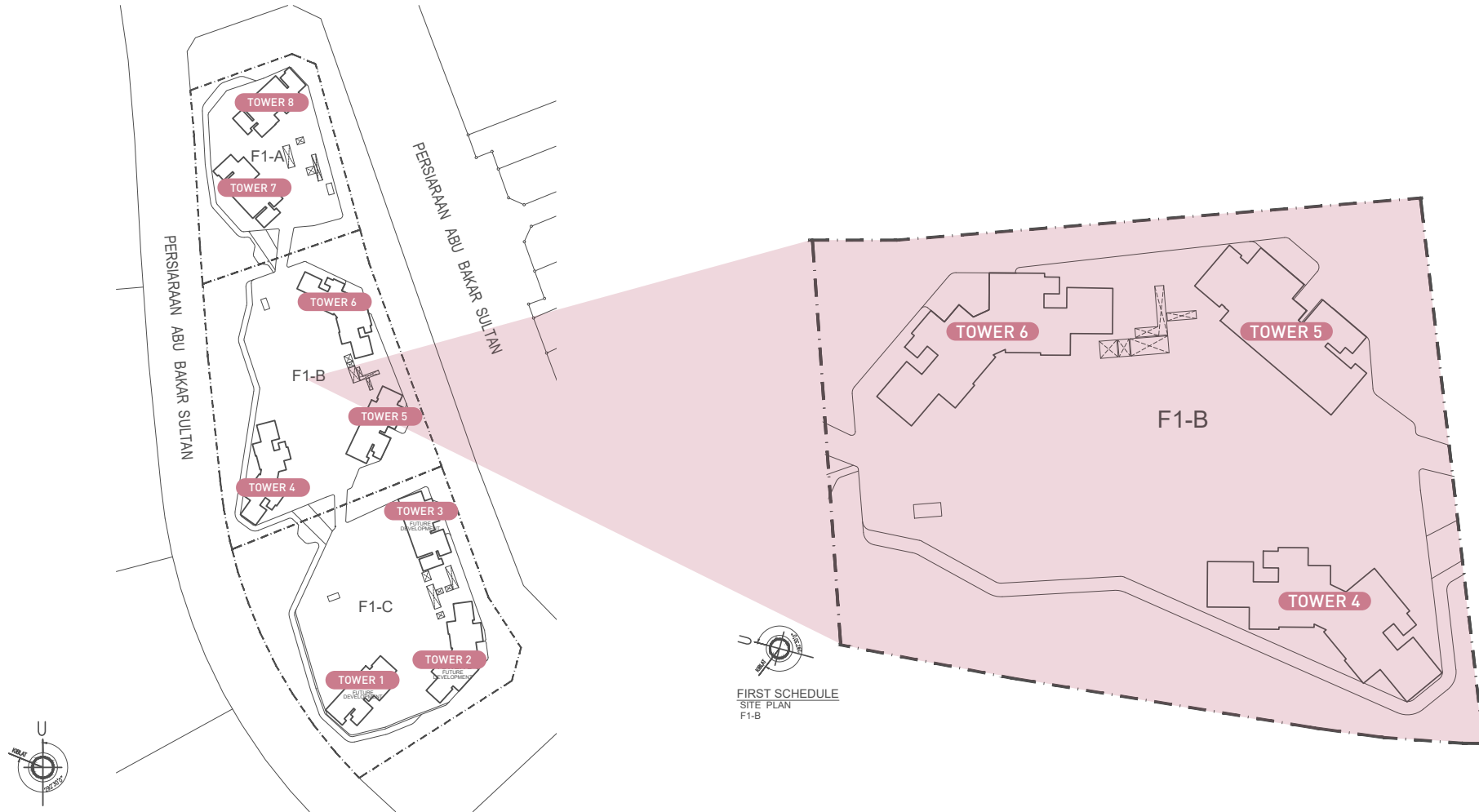

**CONFIDENTIAL. FOR INTERNAL REFERENCE ONLY. PLEASE DO NOT DISTRIBUTE.**

**ALL INFORMATION IS SUBJECT TO CHANGE AND/OR AMENDMENTS AS MAY BE REQUIRED OR AS DIRECTED BY THE RELEVANT AUTHORITIES/ENGINEER(S)/ARCHITECT.**

[DRAFT] FOR PREVIEW ONLY. LAST UPDATED ON 17 AUGUST 2024.



# TYPICAL FLOOR PLAN

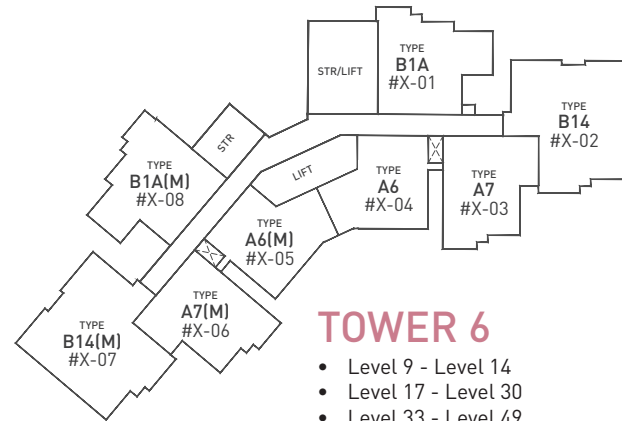

## TOWER 6

- Level 9 - Level 14
  - Level 17 - Level 30
  - Level 33 - Level 49
- \*X = Level

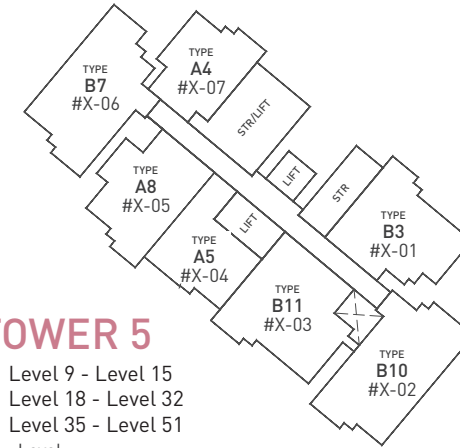

## TOWER 5

- Level 9 - Level 15
  - Level 18 - Level 32
  - Level 35 - Level 51
- \*X = Level

### NOTE:

1. Not to scale.
2. Exterior areas may vary to suit site conditions.
3. The unit number is an indicative number only and does not represent the house numbering in the actual address.
4. Unit numbers, plans, layouts and other information contained herein are intended to give a general indication of the proposed design only and are subject to change and/or amendments as may be required or as directed by the relevant authorities/engineer(s)/ architect.

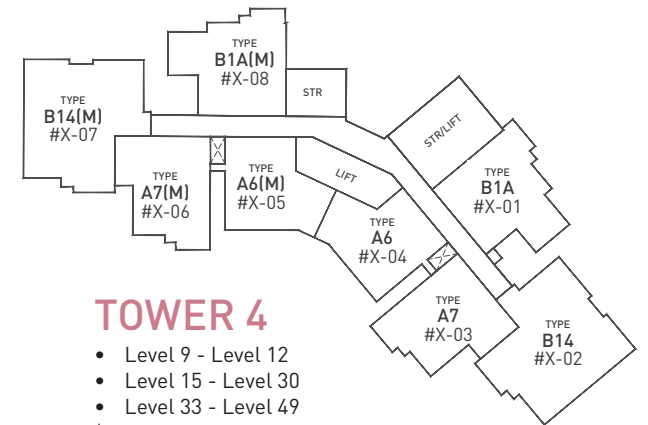
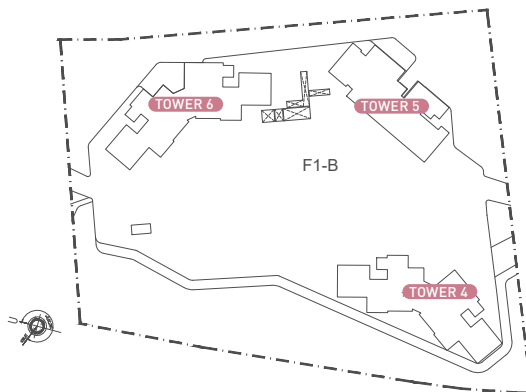

## TOWER 4

- Level 9 - Level 12
  - Level 15 - Level 30
  - Level 33 - Level 49
- \*X = Level

**CONFIDENTIAL. FOR INTERNAL REFERENCE ONLY. PLEASE DO NOT DISTRIBUTE.**

**ALL INFORMATION IS SUBJECT TO CHANGE AND/OR AMENDMENTS AS MAY BE REQUIRED OR AS DIRECTED BY THE RELEVANT AUTHORITIES/ENGINEER(S)/ARCHITECT.**

[DRAFT] FOR PREVIEW ONLY. LAST UPDATED ON 17 AUGUST 2024.

# LEVEL 13 FLOOR PLAN

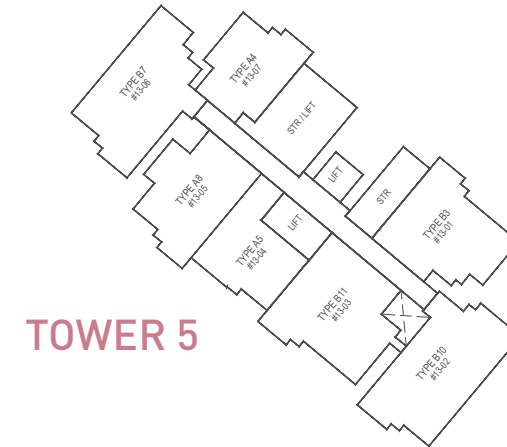
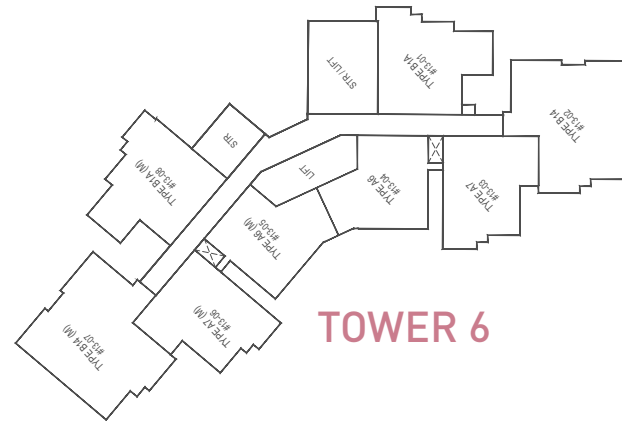

**NOTE:**

1. Not to scale.
2. Exterior areas may vary to suit site conditions.
3. The unit number is an indicative number only and does not represent the house numbering in the actual address.
4. Unit numbers, plans, layouts and other information contained herein are intended to give a general indication of the proposed design only and are subject to change and/or amendments as may be required or as directed by the relevant authorities/engineer(s)/ architect.

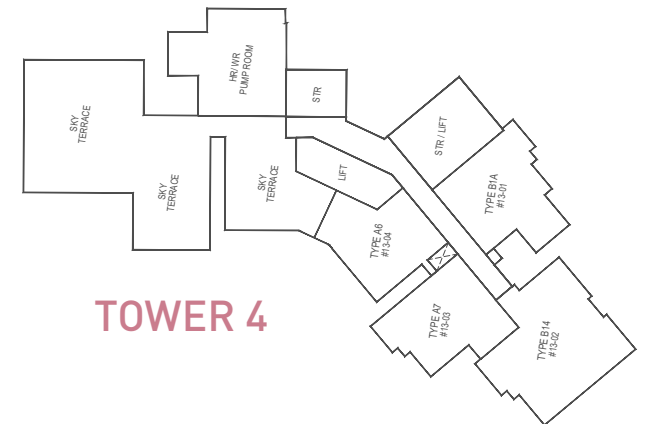
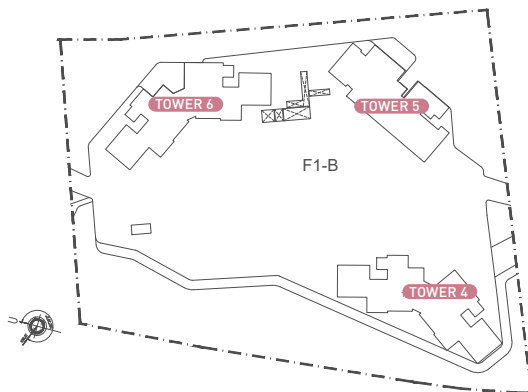

**CONFIDENTIAL. FOR INTERNAL REFERENCE ONLY. PLEASE DO NOT DISTRIBUTE.**

**ALL INFORMATION IS SUBJECT TO CHANGE AND/OR AMENDMENTS AS MAY BE REQUIRED OR AS DIRECTED BY THE RELEVANT AUTHORITIES/ENGINEER(S)/ARCHITECT.**

[DRAFT] FOR PREVIEW ONLY. LAST UPDATED ON 17 AUGUST 2024.

# LEVEL 14 FLOOR PLAN

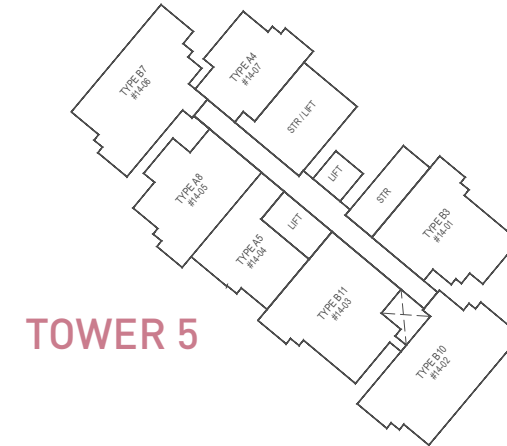
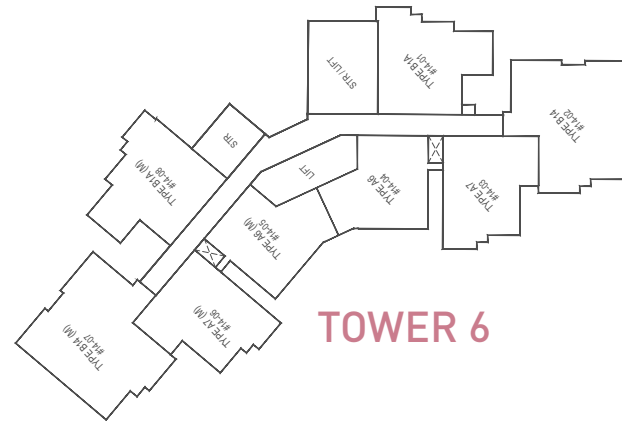

- NOTE:**
1. Not to scale.
  2. Exterior areas may vary to suit site conditions.
  3. The unit number is an indicative number only and does not represent the house numbering in the actual address.
  4. Unit numbers, plans, layouts and other information contained herein are intended to give a general indication of the proposed design only and are subject to change and/or amendments as may be required or as directed by the relevant authorities/engineer(s)/ architect.

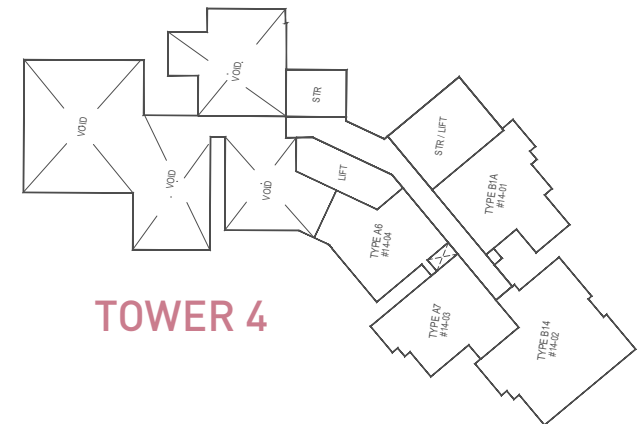
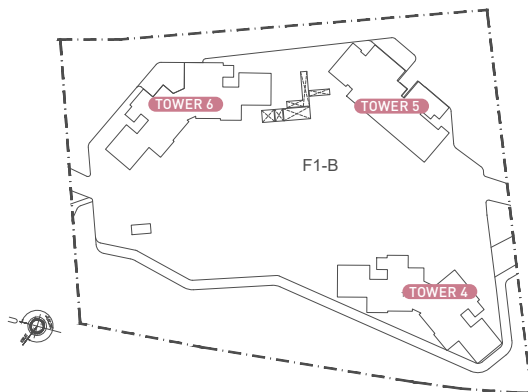



# LEVEL 16 FLOOR PLAN

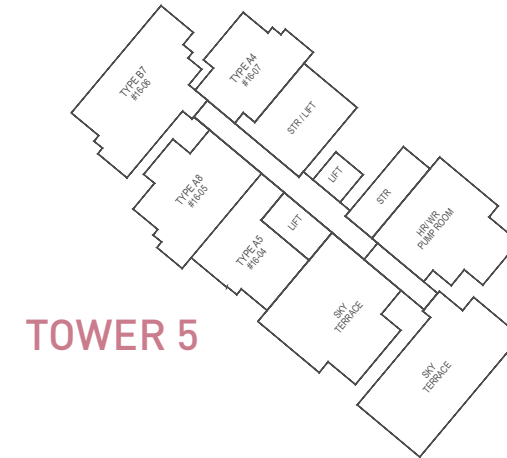
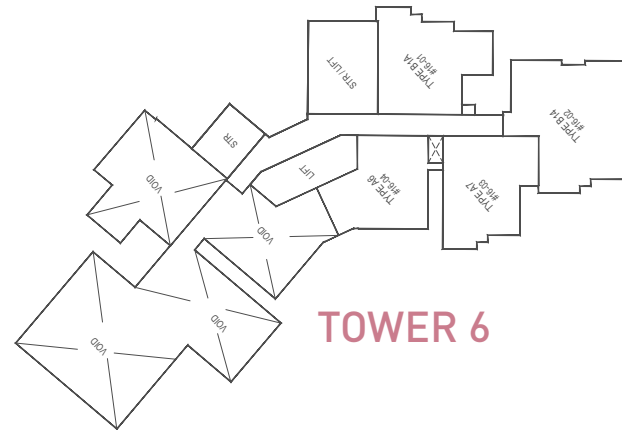

**NOTE:**

1. Not to scale.
2. Exterior areas may vary to suit site conditions.
3. The unit number is an indicative number only and does not represent the house numbering in the actual address.
4. Unit numbers, plans, layouts and other information contained herein are intended to give a general indication of the proposed design only and are subject to change and/or amendments as may be required or as directed by the relevant authorities/engineer(s)/ architect.

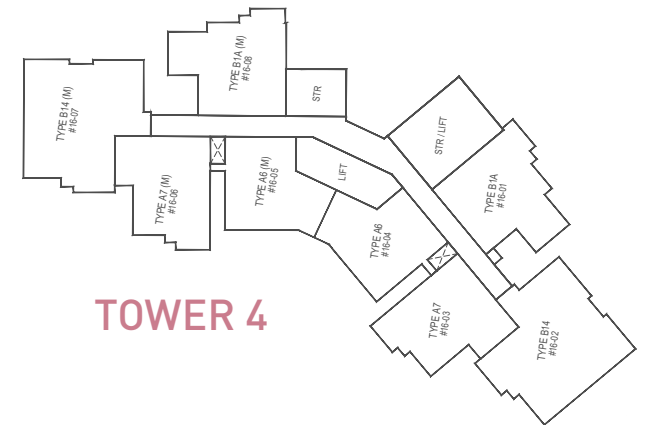
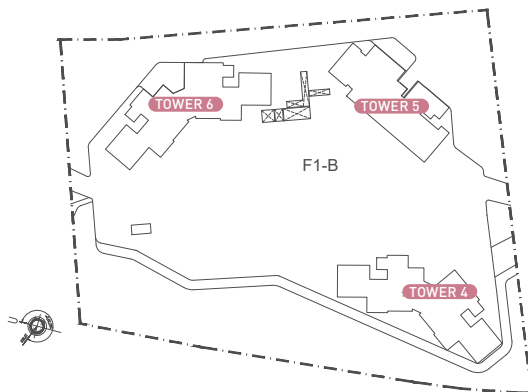

**CONFIDENTIAL. FOR INTERNAL REFERENCE ONLY. PLEASE DO NOT DISTRIBUTE.**

**ALL INFORMATION IS SUBJECT TO CHANGE AND/OR AMENDMENTS AS MAY BE REQUIRED OR AS DIRECTED BY THE RELEVANT AUTHORITIES/ENGINEER(S)/ARCHITECT.**

[DRAFT] FOR PREVIEW ONLY. LAST UPDATED ON 17 AUGUST 2024.

# LEVEL 17 FLOOR PLAN

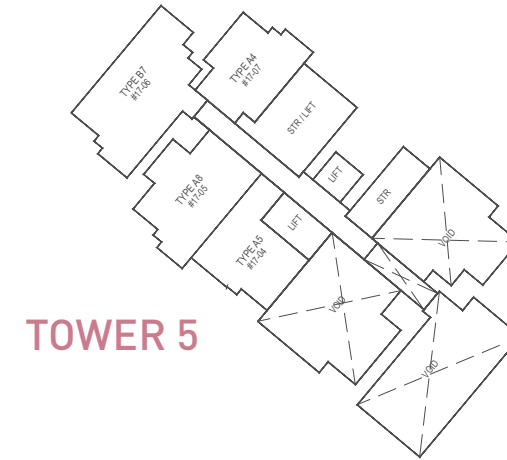
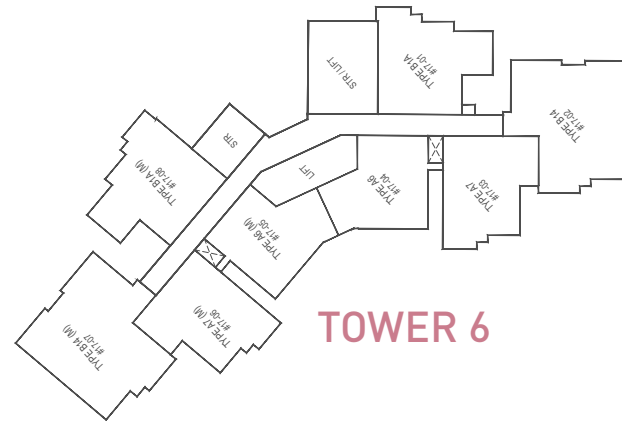

TOWER 5

**NOTE:**

1. Not to scale.
2. Exterior areas may vary to suit site conditions.
3. The unit number is an indicative number only and does not represent the house numbering in the actual address.
4. Unit numbers, plans, layouts and other information contained herein are intended to give a general indication of the proposed design only and are subject to change and/or amendments as may be required or as directed by the relevant authorities/engineer(s)/ architect.

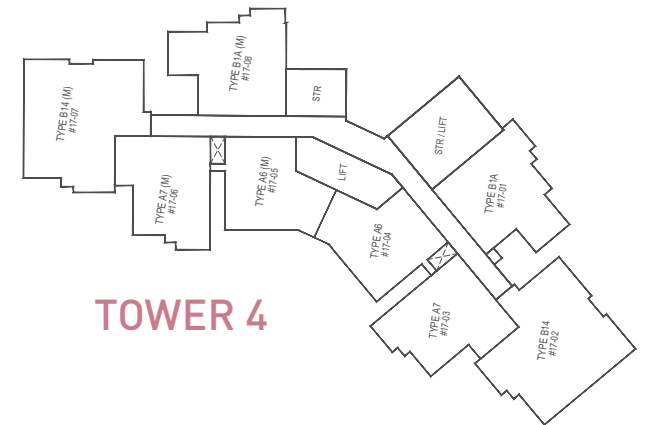
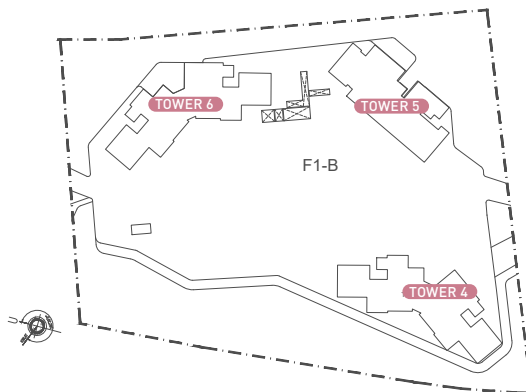

TOWER 4

**CONFIDENTIAL. FOR INTERNAL REFERENCE ONLY. PLEASE DO NOT DISTRIBUTE.**

**ALL INFORMATION IS SUBJECT TO CHANGE AND/OR AMENDMENTS AS MAY BE REQUIRED OR AS DIRECTED BY THE RELEVANT AUTHORITIES/ENGINEER(S)/ARCHITECT.**

[DRAFT] FOR PREVIEW ONLY. LAST UPDATED ON 17 AUGUST 2024.

# LEVEL 31 FLOOR PLAN

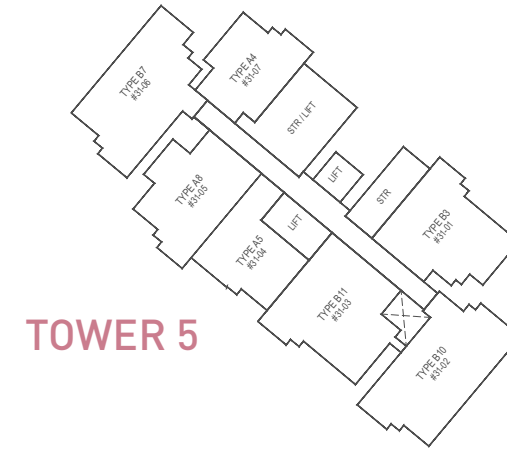
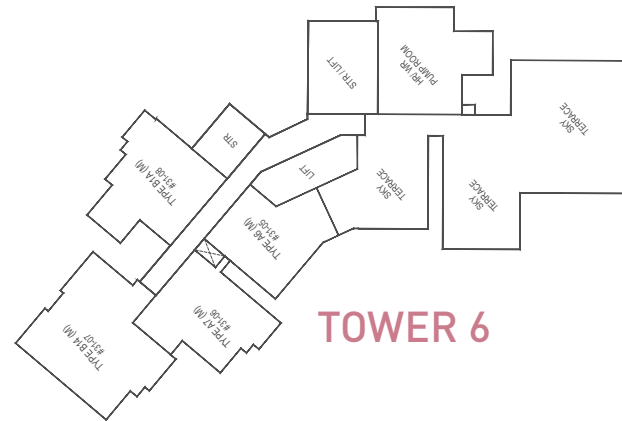

**NOTE:**

1. Not to scale.
2. Exterior areas may vary to suit site conditions.
3. The unit number is an indicative number only and does not represent the house numbering in the actual address.
4. Unit numbers, plans, layouts and other information contained herein are intended to give a general indication of the proposed design only and are subject to change and/or amendments as may be required or as directed by the relevant authorities/engineer(s)/ architect.

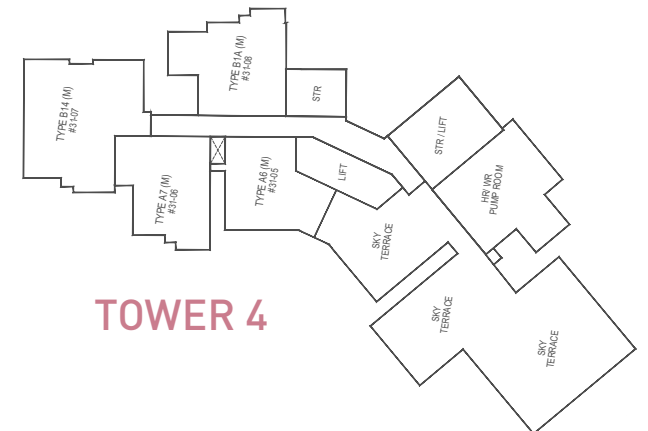
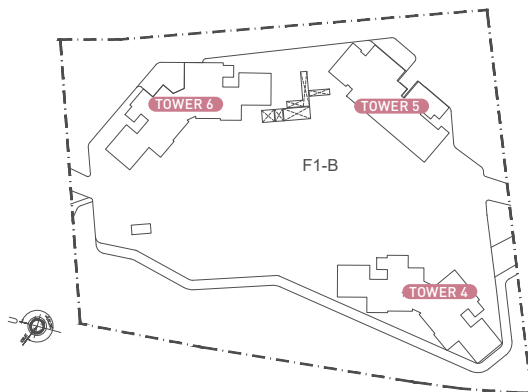

**CONFIDENTIAL. FOR INTERNAL REFERENCE ONLY. PLEASE DO NOT DISTRIBUTE.**

**ALL INFORMATION IS SUBJECT TO CHANGE AND/OR AMENDMENTS AS MAY BE REQUIRED OR AS DIRECTED BY THE RELEVANT AUTHORITIES/ENGINEER(S)/ARCHITECT.**

[DRAFT] FOR PREVIEW ONLY. LAST UPDATED ON 17 AUGUST 2024.

# LEVEL 32 FLOOR PLAN

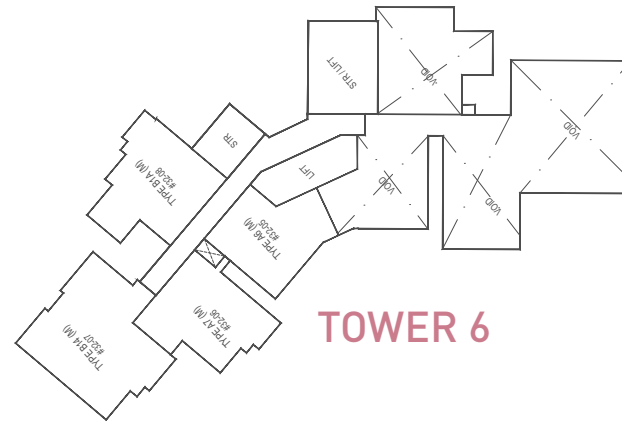

TOWER 6

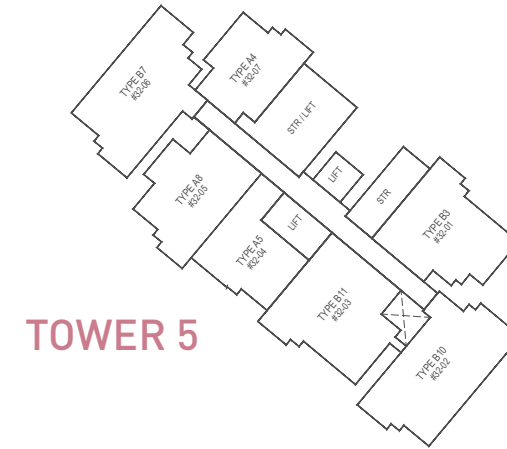

TOWER 5

**NOTE:**

1. Not to scale.
2. Exterior areas may vary to suit site conditions.
3. The unit number is an indicative number only and does not represent the house numbering in the actual address.
4. Unit numbers, plans, layouts and other information contained herein are intended to give a general indication of the proposed design only and are subject to change and/or amendments as may be required or as directed by the relevant authorities/engineer(s)/ architect.

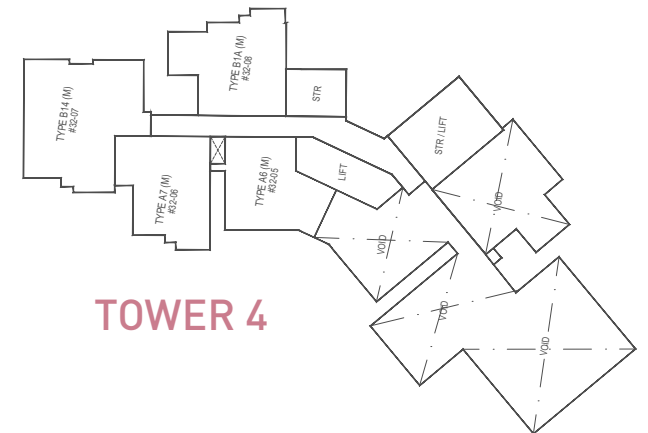
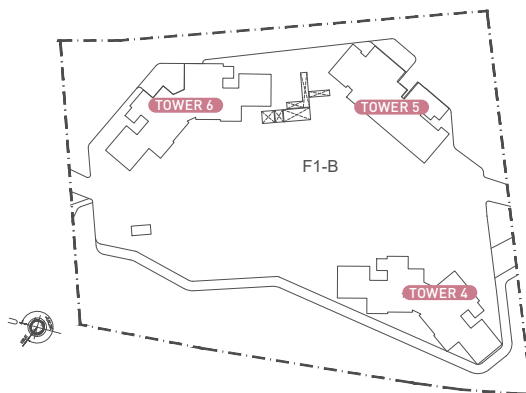

TOWER 4

**CONFIDENTIAL. FOR INTERNAL REFERENCE ONLY. PLEASE DO NOT DISTRIBUTE.**

**ALL INFORMATION IS SUBJECT TO CHANGE AND/OR AMENDMENTS AS MAY BE REQUIRED OR AS DIRECTED BY THE RELEVANT AUTHORITIES/ENGINEER(S)/ARCHITECT.**

[DRAFT] FOR PREVIEW ONLY. LAST UPDATED ON 17 AUGUST 2024.



# LEVEL 34 FLOOR PLAN

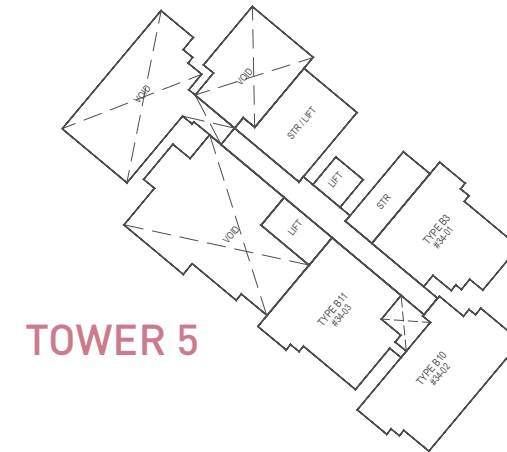
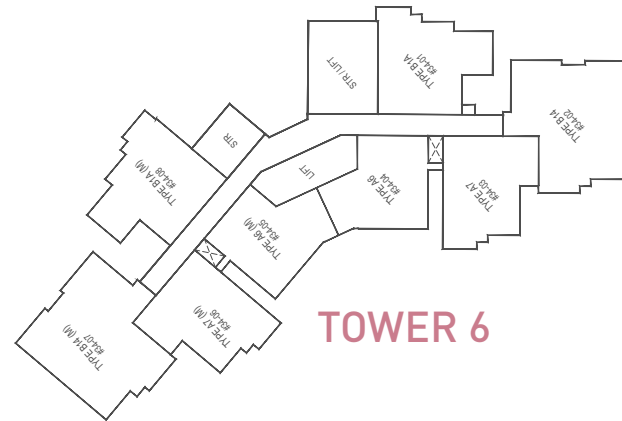

**NOTE:**

1. Not to scale.
2. Exterior areas may vary to suit site conditions.
3. The unit number is an indicative number only and does not represent the house numbering in the actual address.
4. Unit numbers, plans, layouts and other information contained herein are intended to give a general indication of the proposed design only and are subject to change and/or amendments as may be required or as directed by the relevant authorities/engineer(s)/ architect.

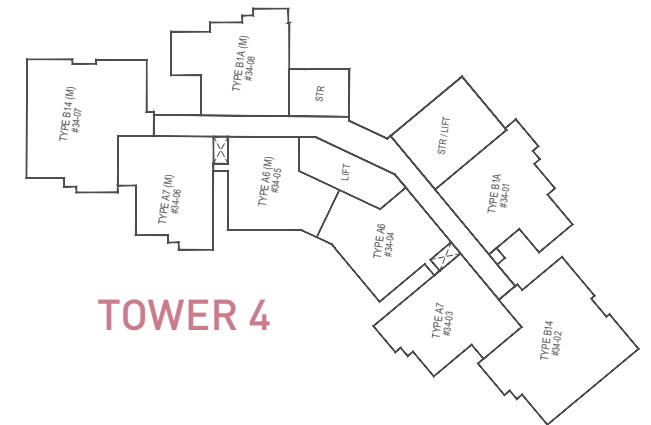
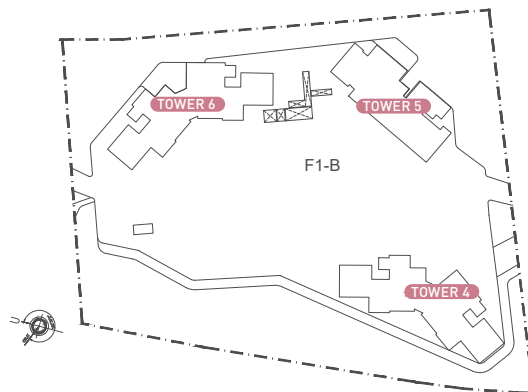

**CONFIDENTIAL. FOR INTERNAL REFERENCE ONLY. PLEASE DO NOT DISTRIBUTE.**

**ALL INFORMATION IS SUBJECT TO CHANGE AND/OR AMENDMENTS AS MAY BE REQUIRED OR AS DIRECTED BY THE RELEVANT AUTHORITIES/ENGINEER(S)/ARCHITECT.**

[DRAFT] FOR PREVIEW ONLY. LAST UPDATED ON 17 AUGUST 2024.

# UNIT PLAN TOWER 4 & 6

**NOTE:**

1. Not to scale. Mirror image. The unit areas, dimensions and layouts shown are approximate only and subject to final survey. Exterior areas may vary to suit site conditions.
2. Unit numbers, plans, layouts and other information contained herein are intended to give a general indication of the proposed design only and are subject to change and/or amendments as may be required or as directed by the relevant authorities/engineer(s)/ architect.

## TYPE A6

- 1 Bedroom + 1 Study Area + 1 Bathroom
- **60 sq m / 639 sq ft**
- Tower 4: 39 units
- Tower 6: 39 units

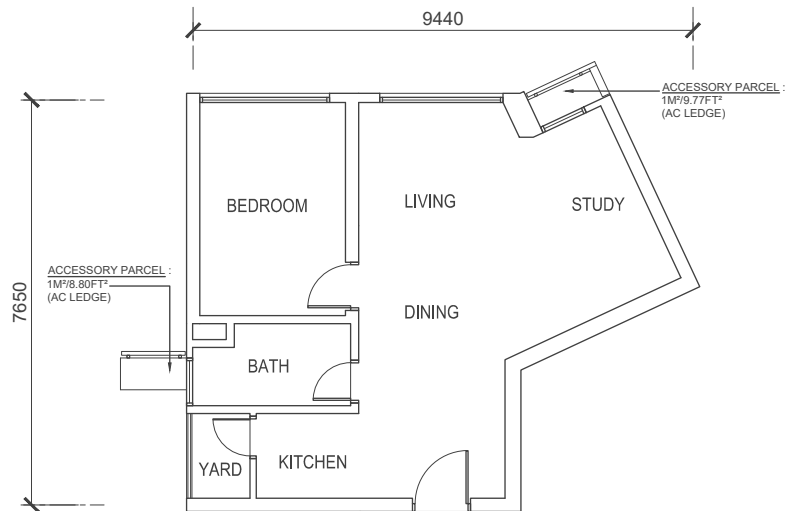

## TYPE A6(M)

- 1 Bedroom + 1 Study Area + 1 Bathroom
- **60 sq m / 639 sq ft**
- Tower 4: 39 units
- Tower 6: 39 units

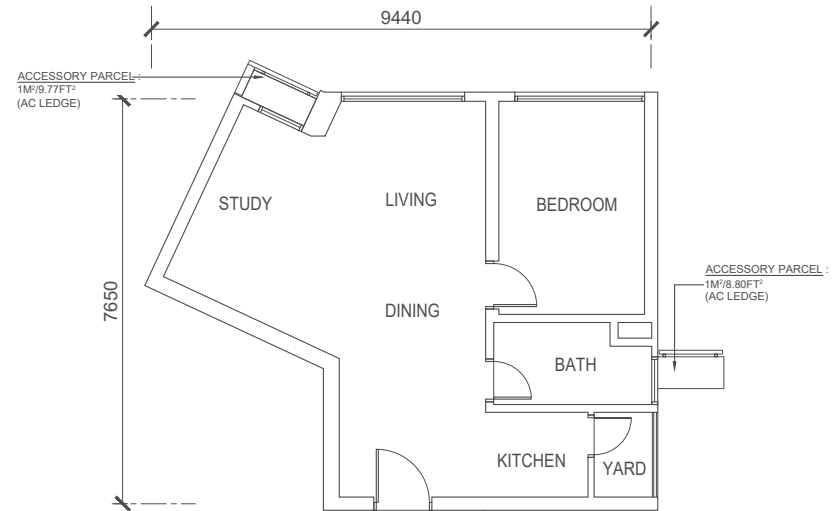

**CONFIDENTIAL. FOR INTERNAL REFERENCE ONLY. PLEASE DO NOT DISTRIBUTE.**

**ALL INFORMATION IS SUBJECT TO CHANGE AND/OR AMENDMENTS AS MAY BE REQUIRED OR AS DIRECTED BY THE RELEVANT AUTHORITIES/ENGINEER(S)/ARCHITECT.**

[DRAFT] FOR PREVIEW ONLY. LAST UPDATED ON 17 AUGUST 2024.

# UNIT PLAN TOWER 4 & 6

**NOTE:**

1. Not to scale. Mirror image. The unit areas, dimensions and layouts shown are approximate only and subject to final survey. Exterior areas may vary to suit site conditions.
2. Unit numbers, plans, layouts and other information contained herein are intended to give a general indication of the proposed design only and are subject to change and/or amendments as may be required or as directed by the relevant authorities/engineer(s)/ architect.

## TYPE A7

- 1 Bedroom + 1 Study Area + 1 Bathroom
- **63 sq m / 679.20 sq ft**
- Tower 4: 39 units

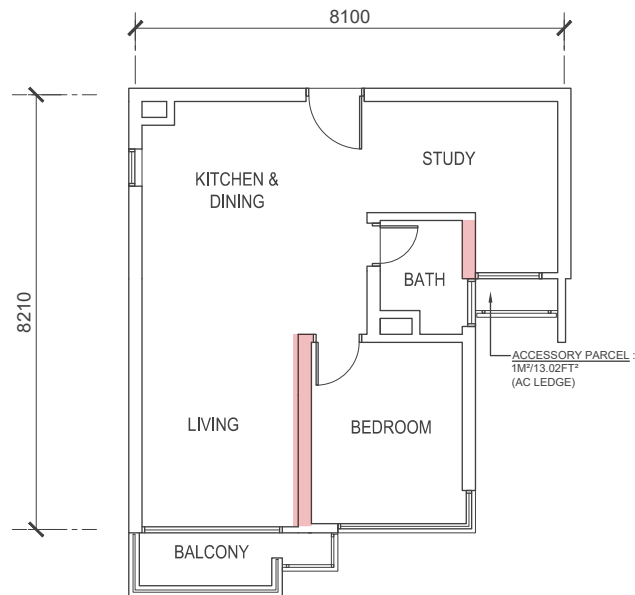

## TYPE A7

- 1 Bedroom + 1 Study Area + 1 Bathroom
- **63 sq m / 679.20 sq ft**
- Tower 6: 39 units

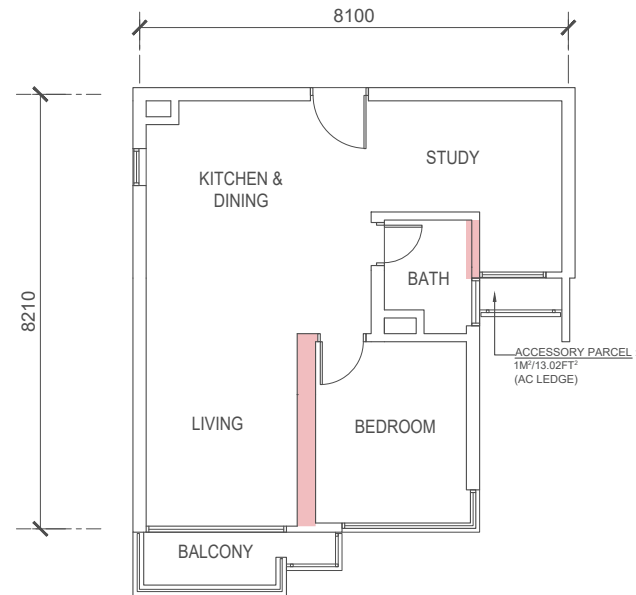

### VARIATION

**CONFIDENTIAL. FOR INTERNAL REFERENCE ONLY. PLEASE DO NOT DISTRIBUTE.**

**ALL INFORMATION IS SUBJECT TO CHANGE AND/OR AMENDMENTS AS MAY BE REQUIRED OR AS DIRECTED BY THE RELEVANT AUTHORITIES/ENGINEER(S)/ARCHITECT.**

[DRAFT] FOR PREVIEW ONLY. LAST UPDATED ON 17 AUGUST 2024.

# UNIT PLAN TOWER 4 & 6

**NOTE:**

1. Not to scale. Mirror image. The unit areas, dimensions and layouts shown are approximate only and subject to final survey. Exterior areas may vary to suit site conditions.
2. Unit numbers, plans, layouts and other information contained herein are intended to give a general indication of the proposed design only and are subject to change and/or amendments as may be required or as directed by the relevant authorities/engineer(s)/ architect.

## TYPE A7(M)

- 1 Bedroom + 1 Study Area + 1 Bathroom
- **63 sq m / 679.20 sq ft**
- Tower 4: 39 units
- Tower 6: 39 units

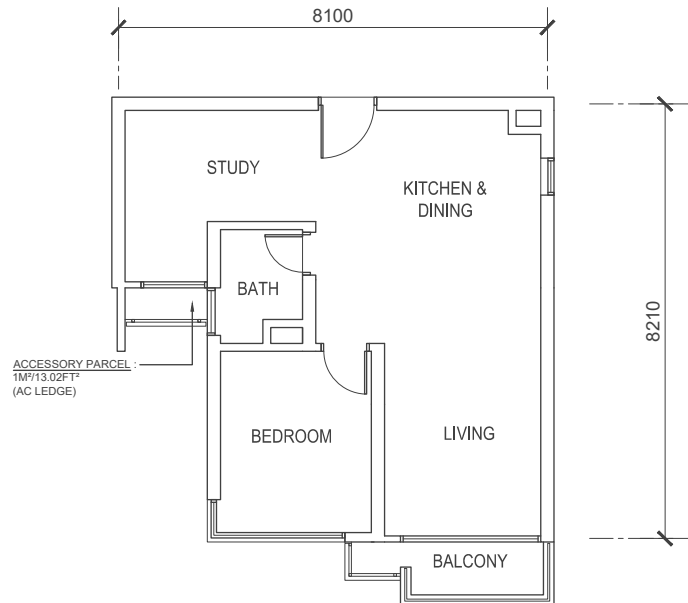

**CONFIDENTIAL. FOR INTERNAL REFERENCE ONLY. PLEASE DO NOT DISTRIBUTE.**

**ALL INFORMATION IS SUBJECT TO CHANGE AND/OR AMENDMENTS AS MAY BE REQUIRED OR AS DIRECTED BY THE RELEVANT AUTHORITIES/ENGINEER(S)/ARCHITECT.**

[DRAFT] FOR PREVIEW ONLY. LAST UPDATED ON 17 AUGUST 2024.

# UNIT PLAN TOWER 4 & 6

**NOTE:**

1. Not to scale. Mirror image. The unit areas, dimensions and layouts shown are approximate only and subject to final survey. Exterior areas may vary to suit site conditions.
2. Unit numbers, plans, layouts and other information contained herein are intended to give a general indication of the proposed design only and are subject to change and/or amendments as may be required or as directed by the relevant authorities/engineer(s)/ architect.

## TYPE B1A

- 1 Bedroom + 1 Study Area + 1 Bathroom
- **68 sq m / 728.61 sq ft**
- Tower 4: 39 units
- Tower 6: 39 units

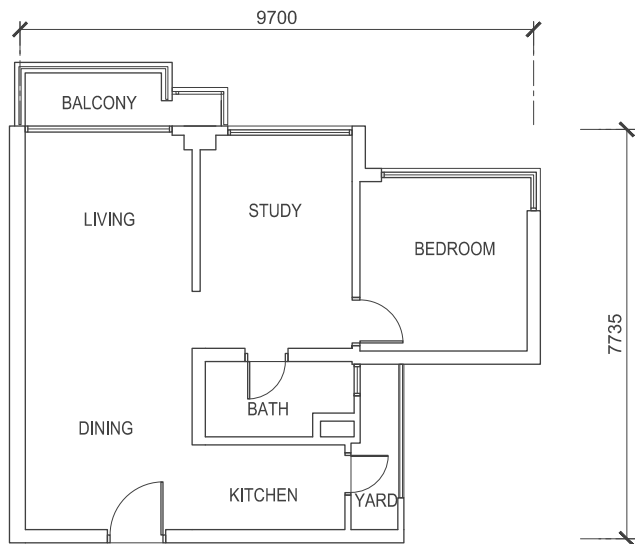

## TYPE B1A(M)

- 1 Bedroom + 1 Study Area + 1 Bathroom
- **68 sq m / 728.61 sq ft**
- Tower 4: 39 units
- Tower 6: 39 units

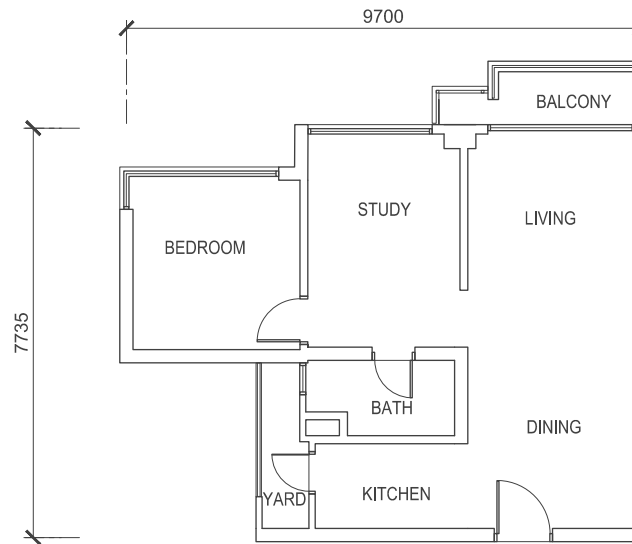

# UNIT PLAN TOWER 4 & 6

**NOTE:**

1. Not to scale. Mirror image. The unit areas, dimensions and layouts shown are approximate only and subject to final survey. Exterior areas may vary to suit site conditions.
2. Unit numbers, plans, layouts and other information contained herein are intended to give a general indication of the proposed design only and are subject to change and/or amendments as may be required or as directed by the relevant authorities/engineer(s)/ architect.

## TYPE B14

- 2 Bedrooms + 1 Study Room + 2 Bathrooms
- **96 sq m / 1029.13 sq ft**
- Tower 4: 39 units

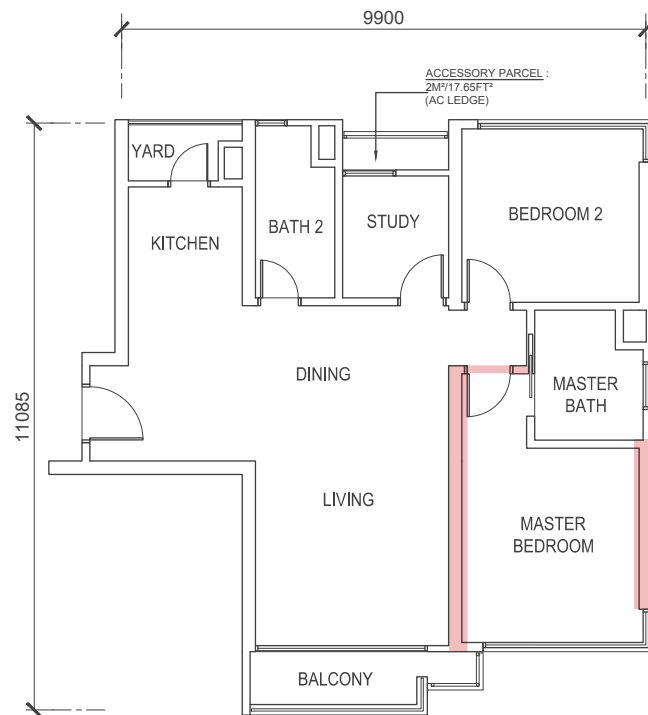

## TYPE B14

- 2 Bedrooms + 1 Study Room + 2 Bathrooms
- **96 sq m / 1027.25 sq ft**
- Tower 6: 39 units

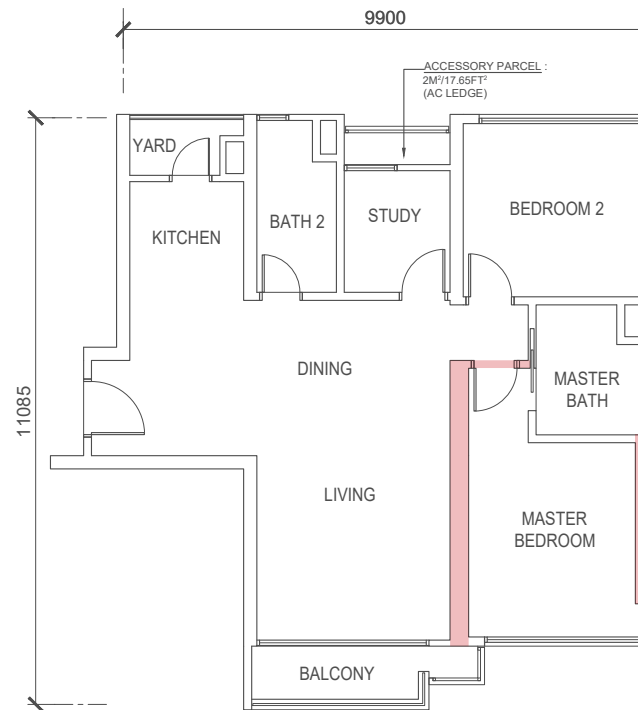

### VARIATION

**CONFIDENTIAL. FOR INTERNAL REFERENCE ONLY. PLEASE DO NOT DISTRIBUTE.**

**ALL INFORMATION IS SUBJECT TO CHANGE AND/OR AMENDMENTS AS MAY BE REQUIRED OR AS DIRECTED BY THE RELEVANT AUTHORITIES/ENGINEER(S)/ARCHITECT.**

[DRAFT] FOR PREVIEW ONLY. LAST UPDATED ON 17 AUGUST 2024.

# UNIT PLAN TOWER 4 & 6

**NOTE:**

1. Not to scale. Mirror image. The unit areas, dimensions and layouts shown are approximate only and subject to final survey. Exterior areas may vary to suit site conditions.
2. Unit numbers, plans, layouts and other information contained herein are intended to give a general indication of the proposed design only and are subject to change and/or amendments as may be required or as directed by the relevant authorities/engineer(s)/ architect.

## TYPE B14(M)

- 2 Bedrooms + 1 Study Room + 2 Bathrooms
- **96 sq m / 1029.13 sq ft**
- Tower 4: 39 units

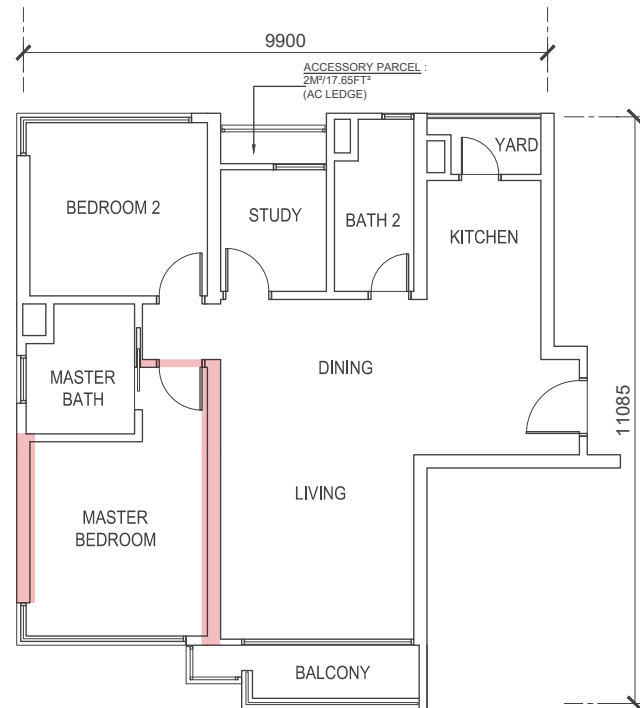

## TYPE B14(M)

- 2 Bedrooms + 1 Study Room + 2 Bathrooms
- **96 sq m / 1027.25 sq ft**
- Tower 6: 39 units

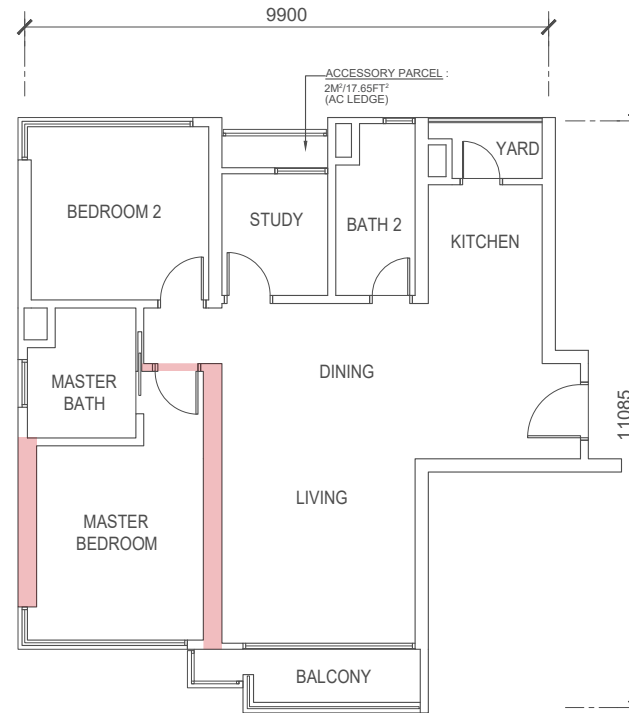

### VARIATION

**CONFIDENTIAL. FOR INTERNAL REFERENCE ONLY. PLEASE DO NOT DISTRIBUTE.**

**ALL INFORMATION IS SUBJECT TO CHANGE AND/OR AMENDMENTS AS MAY BE REQUIRED OR AS DIRECTED BY THE RELEVANT AUTHORITIES/ENGINEER(S)/ARCHITECT.**

[DRAFT] FOR PREVIEW ONLY. LAST UPDATED ON 17 AUGUST 2024.

# UNIT PLAN TOWER 5

## TYPE A4

- 1 Bedroom + 1 Study Area + 1 Bathroom
- **50 sq m / 538.95 sq ft**
- Tower 5: 41 units

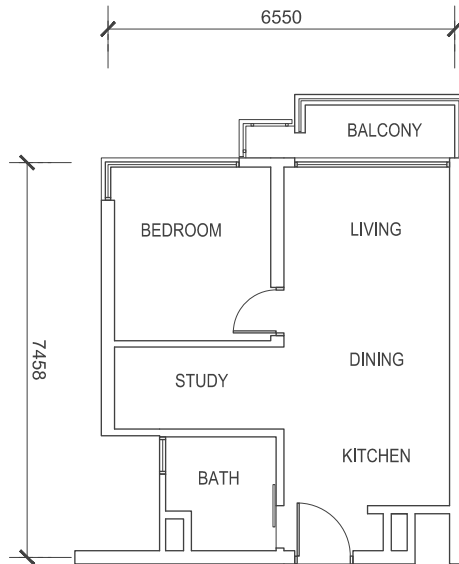

**NOTE:**

1. Not to scale. Mirror image. The unit areas, dimensions and layouts shown are approximate only and subject to final survey. Exterior areas may vary to suit site conditions.
2. Unit numbers, plans, layouts and other information contained herein are intended to give a general indication of the proposed design only and are subject to change and/or amendments as may be required or as directed by the relevant authorities/engineer(s)/ architect.

## TYPE A5

- 1 Bedroom + 1 Bathroom
- **55 sq m / 592.12 sq ft**
- Tower 5: 41 units

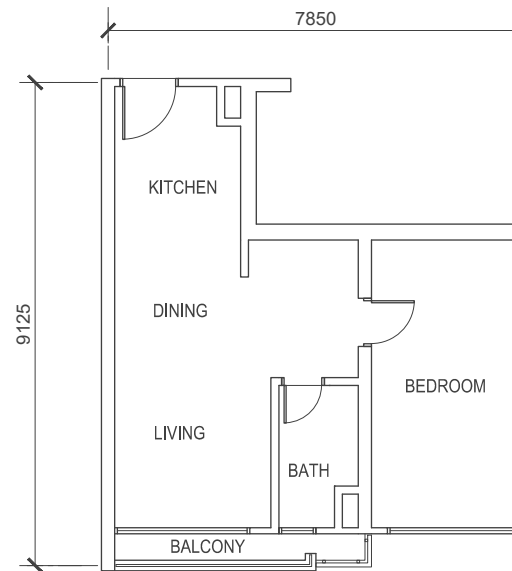

# UNIT PLAN TOWER 5

**NOTE:**

1. Not to scale. Mirror image. The unit areas, dimensions and layouts shown are approximate only and subject to final survey. Exterior areas may vary to suit site conditions.
2. Unit numbers, plans, layouts and other information contained herein are intended to give a general indication of the proposed design only and are subject to change and/or amendments as may be required or as directed by the relevant authorities/engineer(s)/ architect.

## TYPE A8

- 1 Bedroom + 1 Study Area + 1 Bathroom
- **64 sq m / 693.10 sq ft**
- Tower 5: 41 units

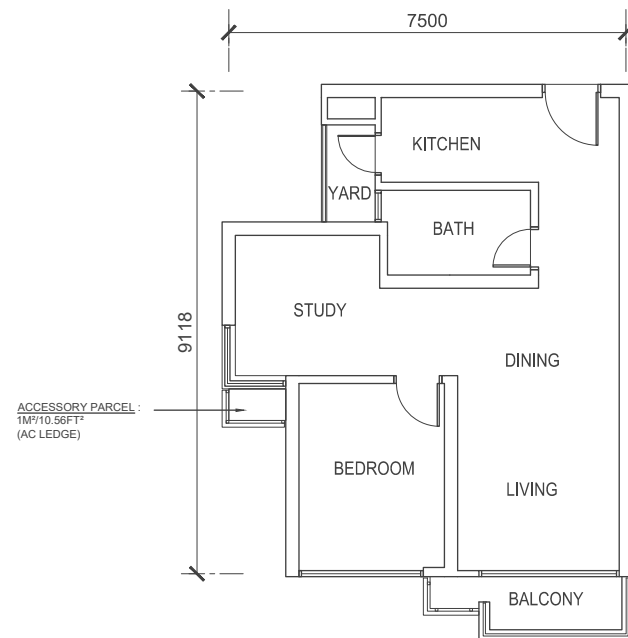

**CONFIDENTIAL. FOR INTERNAL REFERENCE ONLY. PLEASE DO NOT DISTRIBUTE.**

**ALL INFORMATION IS SUBJECT TO CHANGE AND/OR AMENDMENTS AS MAY BE REQUIRED OR AS DIRECTED BY THE RELEVANT AUTHORITIES/ENGINEER(S)/ARCHITECT.**

[DRAFT] FOR PREVIEW ONLY. LAST UPDATED ON 17 AUGUST 2024.

# UNIT PLAN TOWER 5

**NOTE:**

1. Not to scale. Mirror image. The unit areas, dimensions and layouts shown are approximate only and subject to final survey. Exterior areas may vary to suit site conditions.
2. Unit numbers, plans, layouts and other information contained herein are intended to give a general indication of the proposed design only and are subject to change and/or amendments as may be required or as directed by the relevant authorities/engineer(s)/ architect.

## TYPE B3

- 1 Bedroom + 1 Study Area + 1 Bathroom
- **70 sq m / 747.97 sq ft**
- Tower 5: 41 units

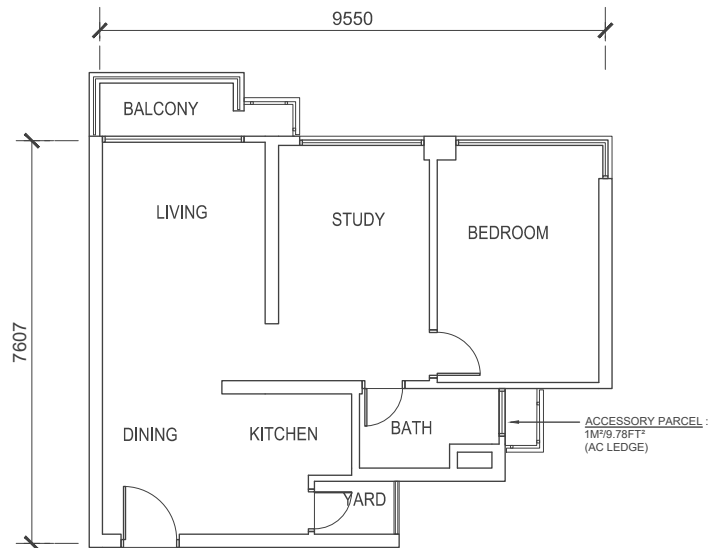

## TYPE B7

- 2 Bedrooms + 1 Study Room + 1 Bathroom
- **80 sq m / 859.72 sq ft**
- Tower 5: 41 units

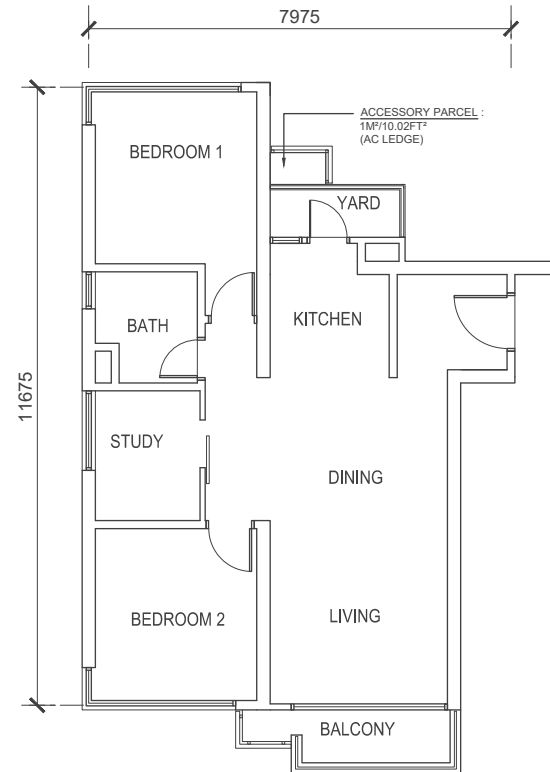

**CONFIDENTIAL. FOR INTERNAL REFERENCE ONLY. PLEASE DO NOT DISTRIBUTE.**

**ALL INFORMATION IS SUBJECT TO CHANGE AND/OR AMENDMENTS AS MAY BE REQUIRED OR AS DIRECTED BY THE RELEVANT AUTHORITIES/ENGINEER(S)/ARCHITECT.**

[DRAFT] FOR PREVIEW ONLY. LAST UPDATED ON 17 AUGUST 2024.

# UNIT PLAN TOWER 5

**NOTE:**

1. Not to scale. Mirror image. The unit areas, dimensions and layouts shown are approximate only and subject to final survey. Exterior areas may vary to suit site conditions.
2. Unit numbers, plans, layouts and other information contained herein are intended to give a general indication of the proposed design only and are subject to change and/or amendments as may be required or as directed by the relevant authorities/engineer(s)/ architect.

## TYPE B10

- 2 Bedrooms + 2 Bathrooms
- **83 sq m / 891.85 sq ft**
- Tower 5: 41 units

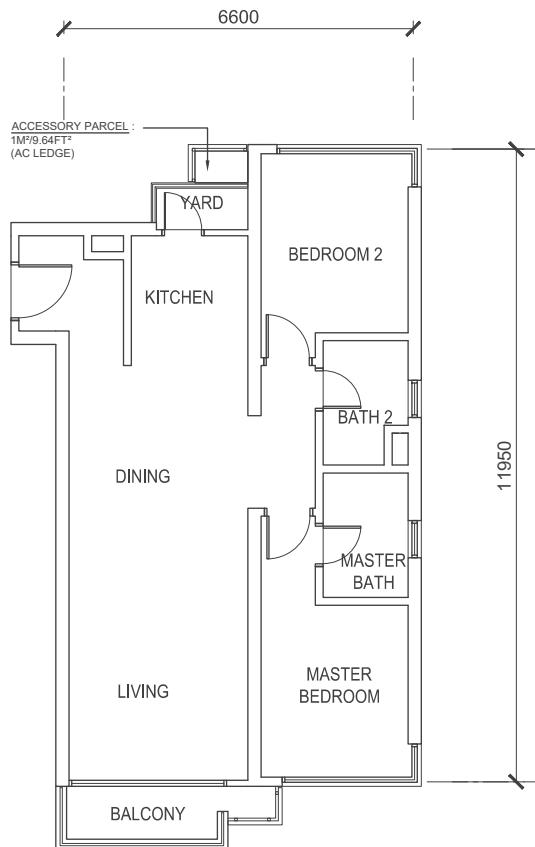

## TYPE B11

- 2 Bedrooms + 2 Bathrooms
- **81 sq m / 874.09 sq ft**
- Tower 5: 41 units

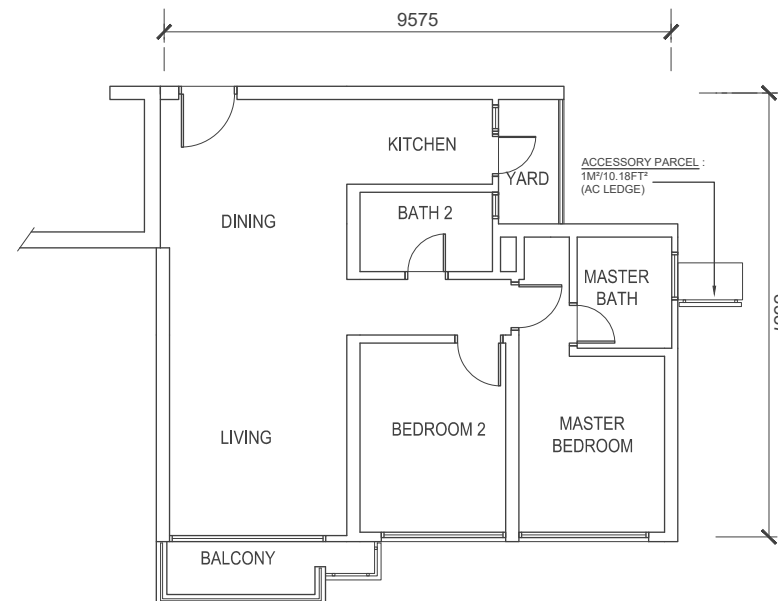

**CONFIDENTIAL. FOR INTERNAL REFERENCE ONLY. PLEASE DO NOT DISTRIBUTE.**

**ALL INFORMATION IS SUBJECT TO CHANGE AND/OR AMENDMENTS AS MAY BE REQUIRED OR AS DIRECTED BY THE RELEVANT AUTHORITIES/ENGINEER(S)/ARCHITECT.**

[DRAFT] FOR PREVIEW ONLY. LAST UPDATED ON 17 AUGUST 2024.

# BUILDING DESCRIPTION

For preview only. Subject to change.

**Structure**

Reinforced Concrete Structure

**Wall**

Reinforced Concrete Wall / Brick Wall / Light Weight Block Wall

**Roof Framing**

Reinforced Concrete Flat Roof

**Ceiling**

Skim Coat / Plaster Ceiling

**Windows**

Aluminium Frame Glass Window

**Doors**

Metal Frame Timber Door  
Aluminium Frame Glass Door

**Ironmongery**

Quality Locksets

**Wall Finishes**

- Kitchen : Wall Tiles Height as per BP / Plaster/ Skim Coat with Emulsion Paint
- Bathroom : Full Height Tiles till Ceiling Level
- Internal : Plaster / Skim Coat with Emulsion Paint
- External : Weather Resistant Paint

**Floor Finishes**

- Living / Dining / Kitchen / Study / All Bedrooms : Tiles
- All Bathrooms : Tiles
- Utility, Yard, Balcony : Tiles
- Other Areas : Cement Render

**All Types**

	Type										
	A4	A5	A6 / A6M	A7 / A7M	A8	B1A / B1AM	B3	B7	B10	B11	B14 / B14M
<b>Sanitary and Plumbing Fittings</b>											
Kitchen Sink	1	1	1	1	1	1	1	1	1	1	1
Wash Basin	1	1	1	1	1	1	1	1	2	2	2
Shower Rose	1	1	1	1	1	1	1	1	2	2	2
W.C.	1	1	1	1	1	1	1	1	2	2	2
Bib Tap	1	1	1	1	1	1	1	1	2	2	2
Washing Machine Tap	1	1	1	1	1	1	1	1	1	1	1
<b>Electrical Installation</b>											
Lighting Point	8	8	9	9	10	9	9	10	11	10	11
Power Point (Include 13A/15A)	9	11	13	11	12	14	12	14	13	13	15
Ceiling Fan Point	2	2	2	2	2	2	2	3	3	3	3
TV Point	2	2	2	2	2	2	2	2	2	2	2
Water Heater Point	1	1	1	1	1	1	1	1	2	2	2
Air-cond Point	3	2	2	3	3	3	3	4	3	3	4
Distribution Board	1	1	1	1	1	1	1	1	1	1	1
<b>Communication</b>											
Fibre Wall Socket Point	1	1	1	1	1	1	1	1	1	1	1

CONFIDENTIAL. FOR INTERNAL REFERENCE ONLY. PLEASE DO NOT DISTRIBUTE.

ALL INFORMATION IS SUBJECT TO CHANGE AND/OR AMENDMENTS AS MAY BE REQUIRED OR AS DIRECTED BY THE RELEVANT AUTHORITIES/ENGINEER(S)/ARCHITECT.

[DRAFT] FOR PREVIEW ONLY. LAST UPDATED ON 17 AUGUST 2024.

